

**VP Vinpra®**

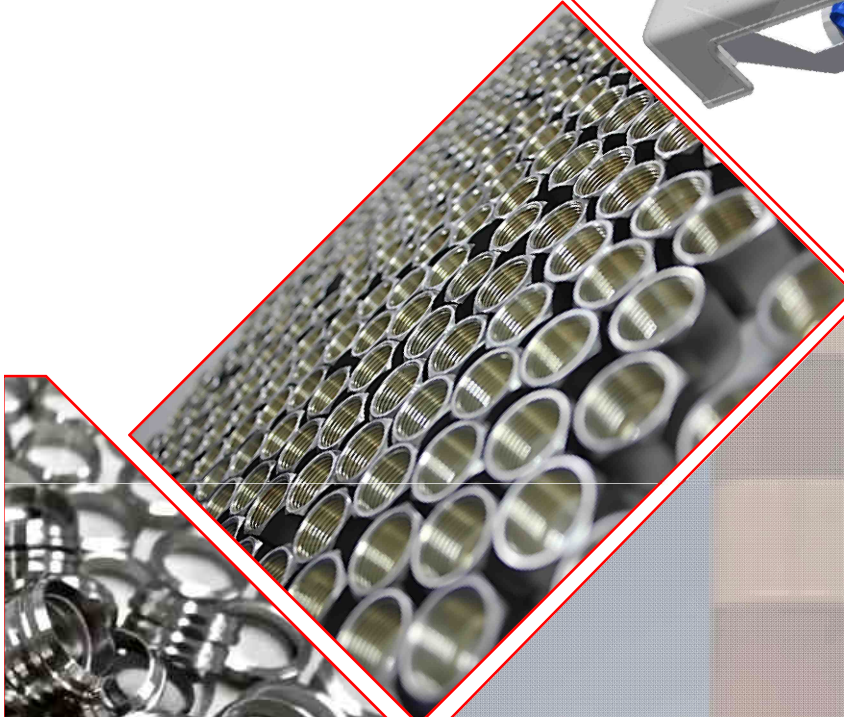
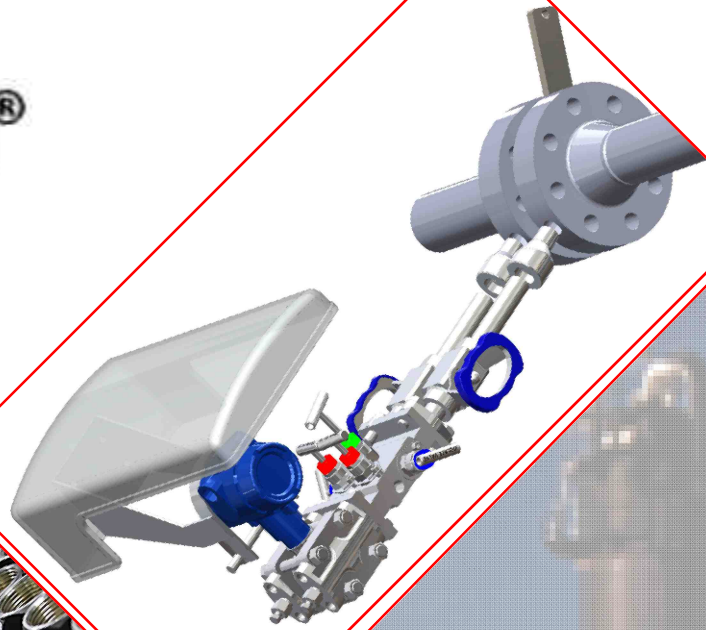

[sales@vinpra.in](mailto:sales@vinpra.in)

## PRODUCT RANGE

- INSTRUMATATION TUBE FITTINGS
- PIPE FITTINGS
- NEEDLE VALVES
- INSTRUMATATION MANIFOLDS
- LOW & HIGH PRESSURE BALL VALVES
- SINGLE PIECE BALL VALVES
- DIVERTER BALL VALVES
- DOUBLE BLOCK AND BLEED VALVES
- MANO FLANGES
- FLUSHING RING
- FLANGE END BALL VALVE
- AIR HEADER
- CONDENSATE POT
- FLANEGS
- ORIFICE FLANGES
- SAMPLING CYLINDERS
- GATE & GLOBE VALVES
- SUNSHDE & MOUNTING ACCESSORIES
- TUBE CLAMP
- CHAMBERS
- METERING SKID
- SPOOL ASSEMBLY
- HEATING JACKET
- FLOW STRAIGHTENERS
- ORIFICE PLATE
- ORIFICE ASSEMBLY



## SINGLE PIECE DOUBLE BLOCK AND BLEED VALVE

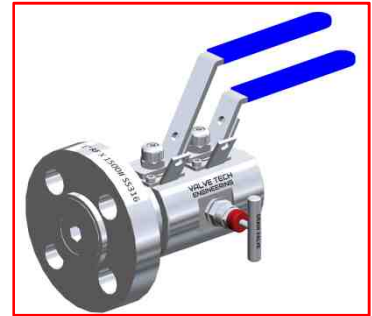
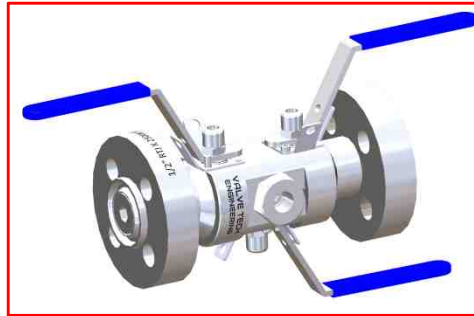
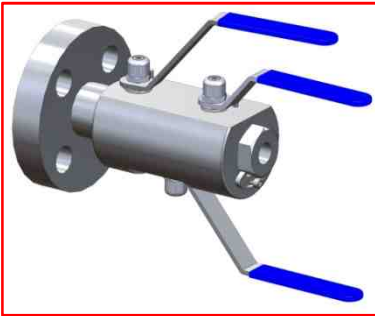

### Combinations

- Ball x Needle x Ball
- Ball x OS&Y x Ball
- Ball x Ball x Ball

### Pressure Rating

150 TO 2500 Class

### Orifice Sizes

10mm/12mm/14mm.

### Key Features

- ANSI B16.5 150 to 2500 flange class and API 10000
- 1/2" to 3" N.B. Flanges.
- FET Class A Compliance
- Anti blowout stem
- Low torque operation
- One-piece forged construction
- Floating and Trunnion mounted design
- Full hydrostatic and Low-pressure air tested
- Firesafe designed to meet API 607, BS6755
- Raised face and ring type joint flange face styles.

## MONOFLANGE VALVES

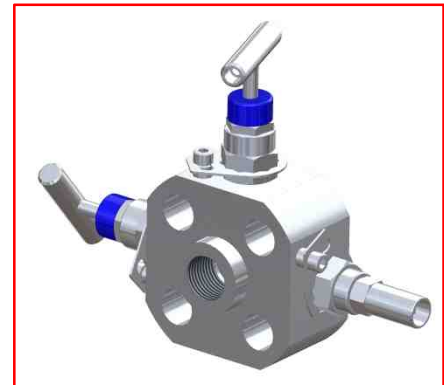

### Pressure Rating

150 To 2500 Class

### Orifice Sizes

4mm / 6mm / 8mm / 10mm

### Key Features

- ANSI B16.5 150 to 2500 flange class and API 10000
- One-piece forged construction
- FET Class A Compliance
- Anti-blow out spindle
- Integral Valve Seat – Metal to Metal Seated
- Non rotating tip - self centering & anti – galling
- Available in either PTFE or Grafoil
- Precision machined to give leak free operation for the life of the valve.

## CRYOGENIC BALL VALVE

### Key Features

- Flange end as per ANSI B16.5, Class 150 to 2500
- Screwed and socket weld end as per ASME b 16.11
- FET Class A Compliance
- Anti blowout stem
- Low torque operation
- Bolted Body forged construction
- Floating and Trunnion mounted design
- Hydrostatic and Low pressure air tested
- Firesafe designed to meet API 607, BS6755
- Raised face and ring type joint flange face styles
- Range of exotic material.

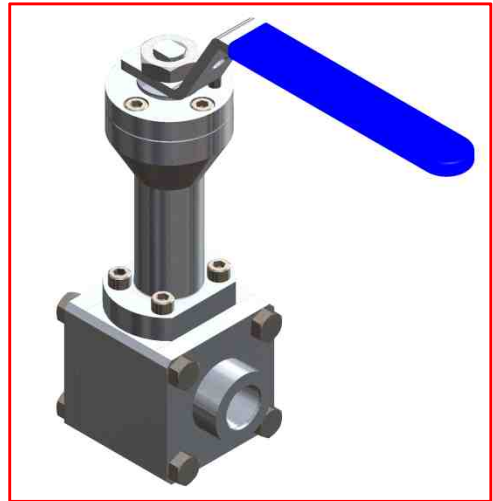

## CLOSE COUPLED HOOK UPS

### PRESSURE HOOK UP

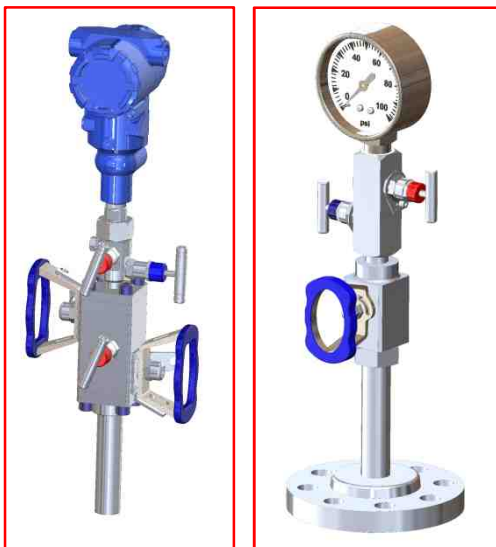

### FLOW HOOK UP

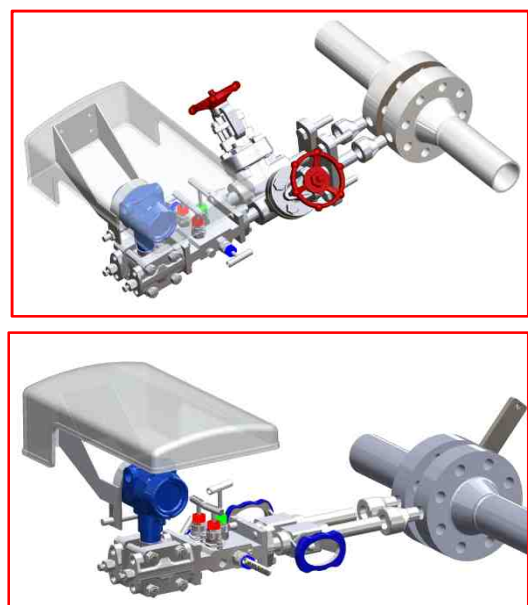

### Key Features

- Working Temp. up to 200°C
- Isolation valve – Ball / Gate / Globe
- FET Class A Compliance
- Low torque operation
- Compact design
- Minimum joints
- Reduce installation time
- 100% Factory tested
- Firesafe design
- Range of exotic material.
- End connection as per client requirement



## NEEDLE VALVE

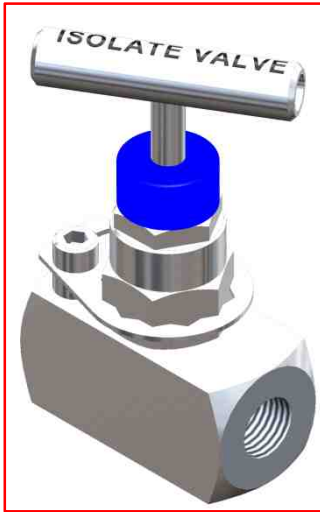

### Key Features

- FET Class A Compliance
- Anti-blow out spindle
- Integral Valve Seat – Metal to Metal Seated
- Non rotating tip - self centering & anti – galling
- Available in either PTFE or Graphoil
- Precision machined to give leak free operation for the life of the valve.

### Orifice Sizes

4mm / 6mm / 8mm / 10mm

### Pressure Rating

3000 / 6000 / 10000psig

## MANIFOLDS (2,3,4 & 5 VALVE)

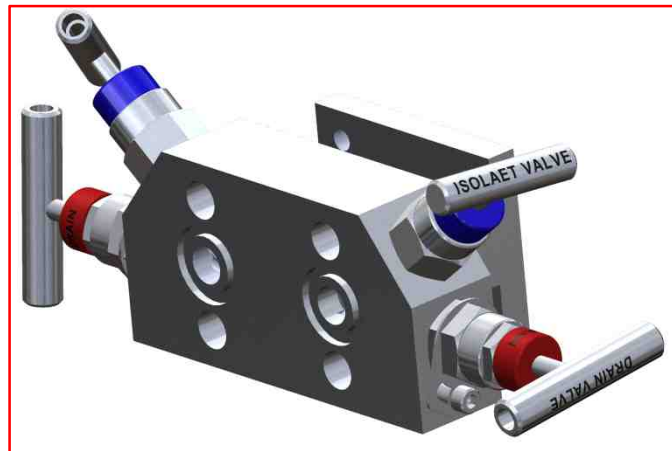
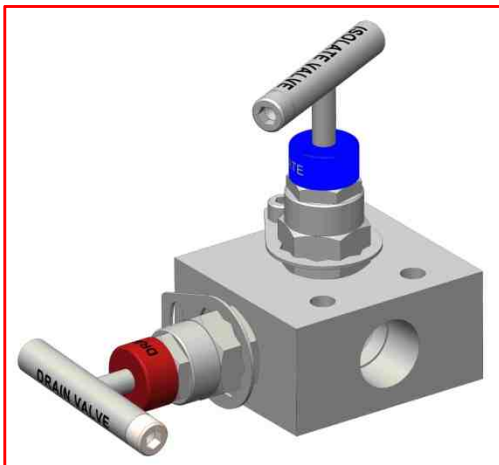

### Key Features

- 2, 3, 4 or 5 valve manifolds offer various levels of process control & measurement
- Remote (or pipe) mounting can be independently mounted
- Anti-blow out spindle
- FET Class A Compliance
- Integral Valve Seat – Metal to Metal Seated
- Non rotating tip - self centering & anti – galling
- Available in either PTFE or Graphoil
- Direct (or flange) mounted manifolds reduces the number of connections and possible leak points

### Pressure Rating

3000 / 6000 / 10000psig

### Orifice Sizes

4mm / 6mm

## HIGH PRESSURE BALL VALVE

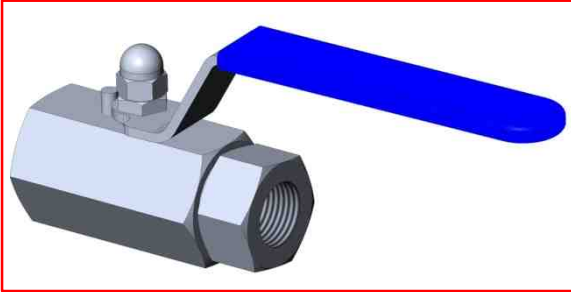

### Key Features

- Anti blowout stem
- Screwed and socket weld end as per ASME b 16.11
- FET Class A Compliance
- Low torque operation
- Full hydrostatic and low pressure air tested
- Bi-directional
- Two piece body design - minimal leakage paths
- Firesafe designed to meet API 607, BS6755

### Pressure Rating

6000 / 10000 psig

### Orifice Sizes

6mm / 10mm / 15mm / 19mm / 25MM / 38MM / 48MM

## GATE , GLOBE & SAMPLING VALVES

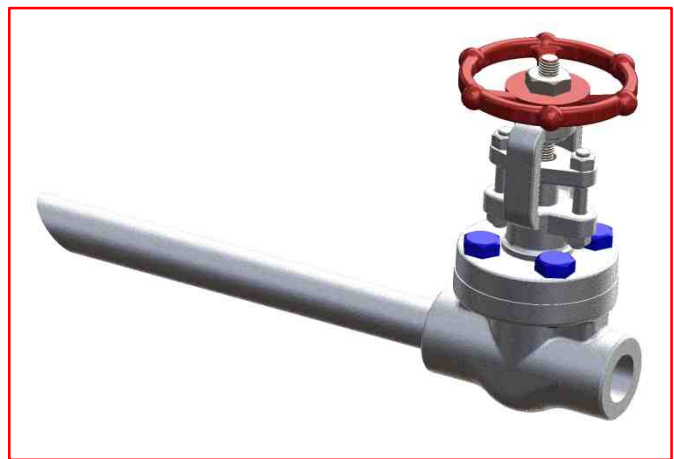
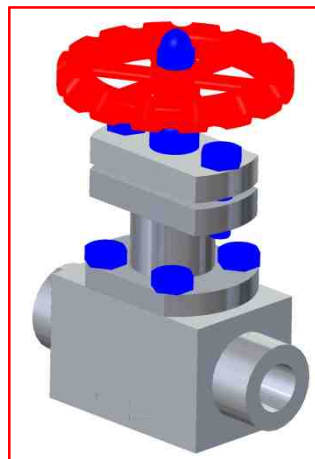

### Pressure Rating

150 TO 2500 CLASS

### Orifice Sizes

Reduce & Full Bore

### Key Features

- ASME B16.34 - BS 5352
- Testing according to API 598
- Marking MSS SP25
- Outside Screw and Yoke (OS&Y)
- Self aligning two piece packing gland
- Integral back seat
- Body bonnet weld to ASME IX Or Bolting
- Solid disc
- Socket Weld Ends to ASME B16.11
- Screwed Ends (NPT) to ASME B1.20.1
- Butt Welding Ends to ASME B16.25

## BOLTED BODY FULL BORE DOUBLE BLOCK AND BLEED VALVE

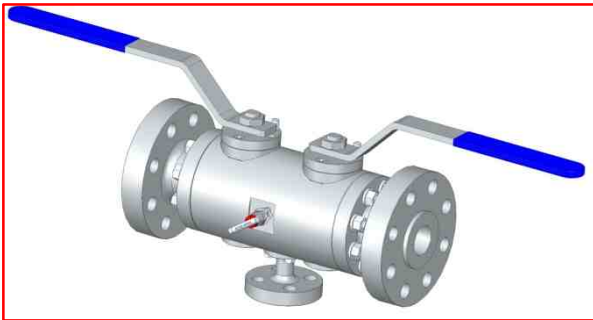

### Key Features

- ANSI B16.5 150 to 2500 flange class
- FET Class A Compliance
- 1/2" to 3" N.B. Flanges (15 to 50 DN).
- Anti blowout stem
- Low torque operation
- Bolted Body forged construction
- Floating and Trunnion mounted design
- Hydrostatic and Low pressure air tested
- Firesafe designed to meet API 607, BS6755
- Raised face and ring type joint flange face styles.

### Combinations

- Ball x Needle x Ball
- Ball x OS&Y x Ball
- Ball x Ball x Ball

### Orifice Sizes

Reduce & Full bore valve design.

### Pressure Rating

150 TO 2500 Class

## LOW PRESSURE BALL VALVES



### Key Features

- Anti-blow out spindle
- One-piece ball stem
- Single piece body design
- 2-way, 3-way, 4-way, 5-way

### Orifice Sizes

4mm / 6mm / 10mm

### Pressure Rating

1000 / 3000 Psig

## FLUSHING RING

### Key Features

- 1/4" or 1/2" NPT female thread
- Sealing faces as per ASME B 16.5 RF & RTJ
- Material collection in front of the diaphragm can be flushed out through the lateral flushing bore holes.

### Pressure Rating

150 To 2500 Class

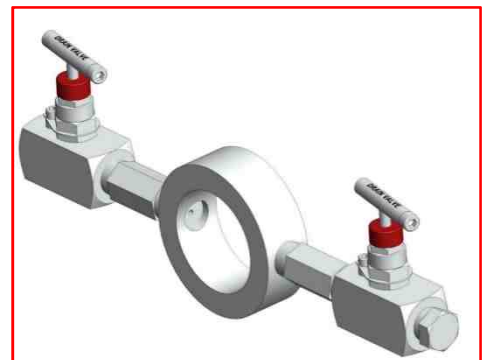



## BALL VALVE SOFT & METAL SEATED

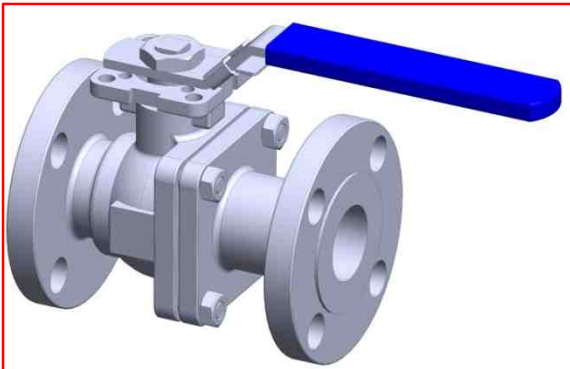

### Key Features

- ANSI B16.5 150 to 600 flange
- FET Class A Compliance
- 1/2" to 6" N.B. Flanges
- Anti blowout stem
- Low torque operation
- Two or Three piece construction
- Floating & Trunnion mounted design
- Full hydrostatic and low pressure air tested
- Firesafe designed to meet API 607, BS6755
- Raised face and ring type joint flange face styles.

### Pressure Rating

150 TO 600 Class

### Orifice Sizes

Reduce & Full bore valve design.

## AIR HEADERS

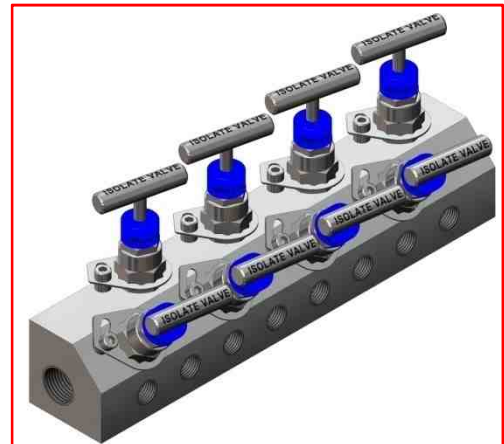
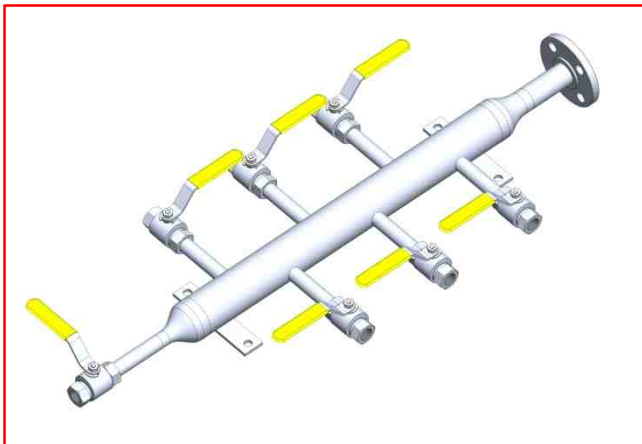

### Key Features

- Inlet flange end as per ASME or EN
- Minimum 4 to 20 way outlets.
- Outlet types Ball valve, Needle valve, Tube fittings & Threaded.
- Locking Handle
- Mounting Bracket
- Body Size 1", 1.5" & 2"
- Bar stock single piece & compact design available



## CONDENSATE POT

### Key Features

- Pipe size 1" to 4".
- Available in 0.5L to 3L.
- Sch. range 40, 80 & 160.
- Non IBR & IBR with Form IIIC.
- Range of exotic material.



## FLANGES

### Key Features

- As per ASME B 16.5 & API 6A
- Size ½" to 4".
- Weld neck, Socket weld, Threaded, Blind, Slip-on, Lap joint, Orifice Flanges available.
- Flange face type Flat face, Raised face, Ring joint.
- Range of exotic material.

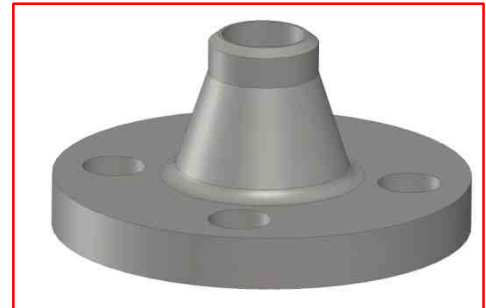

## SAMPLING CYLINDERS

### Key Features

- Single piece seamless body.
- Working pressure 5000 psig.
- Cold-formed female NPT Thread
- Single & Double ended cylinders



## SUNSHADE AND MOUNTING ACCESSORIES

### Key Features

- UV-Resistant
- Easy access to the transmitter, also allowing good lateral access.
- Color: similar to RAL 7032 light grey
- Material: Hot-pressed, Glassfibre reinforced polyester
- Low flammability and self-extinguishing



**OTHER PRODUCTES**

**CHAMBERS**

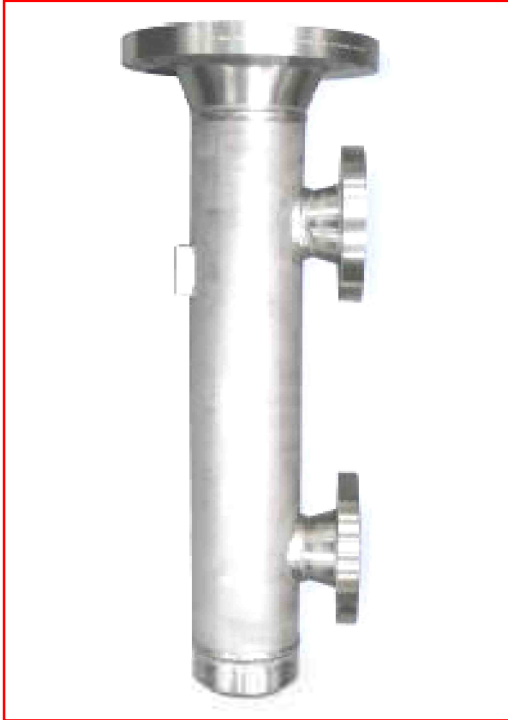

**METERING SKID**



**ORIFICE PLATE**



**ORIFICE ASSEMBLY**



**OTHER PRODUCTES**

**HEATING JACKET**



**FLOW STRAIGHTENERS**



**SPOOL ASSEMBLY**





**VP Vinpra®**

**VP Vinpra® ENGINEERING INDIA PVT. LTD.**  
YOUR GLOBAL PARTNER FOR ENGINEERING PRODUCTS & SERVICES

**Registered Office**

A- 38, Second Floor, Lane No. 2, Madhu Vihar , New Delhi - 110092, (India)

**Factory Office**

Plot no. 30,31, Village kolgaon, Palghar East, Dist Palghar, Maharastra-401404(India)

**Phone Number**

+91 9310304064

**Email**

sales@vinpra.in, vd@vinpra.in

[www.vinpra.in](http://www.vinpra.in)